

| Model | MX-402H | |
|----------------------|-----------------|---------|
| Mark | CV (CE) | RV (RE) |
| 1 Front casing | GFRPP | |
| 2 Impeller | GFRPP | |
| 3 Rear casing | GFRPP | |
| 4 Magnet capsule | PP | |
| 5 O-ring | FKM* | |
| 6 Spindle | Alumina Ceramic | |
| 7 Bearing | Carbon | PTFE |
| 8 Rear thrust | CFRPEEK | |
| 9 Mouth ring | PTFE | |
| 10 Thrust/Liner ring | Alumina Ceramic | |
| 11 Lock pin | GFRPPS | |

* EPDM and AFLAS® O-ring also available.

MX-402H 2 HP

- Engineered to meet the most severe operating conditions.
- When fitted with a carbon bearing, the MX will allow for brief periods of dry running.
- The MX Series is the first resin magnet pump that uses a *Split Volute Pump Casing* that forms a vortex chamber.
- Self-radiating structure (patent pending) – Heat dispersion holes force the liquid to circulate around the spindle and bearing .

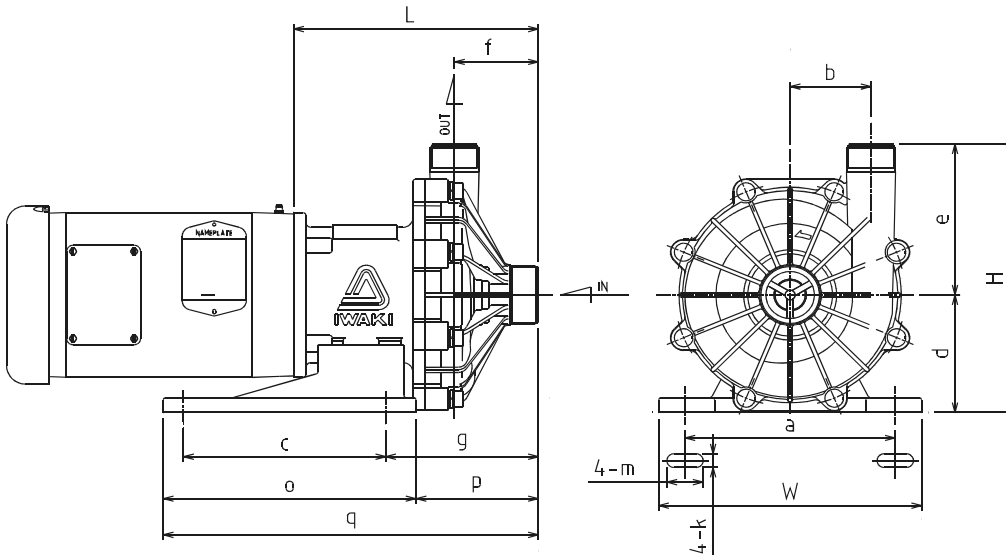

Dimensions (in inches)

| a | b | c | d | e | f | g | k | n | o | p | q | W | H | L |
|------|------|------|------|------|------|------|-----|------|------|------|-------|-------|-------|------|
| 8.19 | 3.15 | 7.87 | 4.72 | 6.06 | 3.27 | 5.94 | .47 | 1.42 | 9.84 | 4.76 | 14.61 | 10.24 | 10.78 | 9.53 |

Specifications

| Suction x Discharge | Maximum Discharge Pressure | Maximum Flow | Specific Gravity | Weight (less motor) |
|---------------------|----------------------------|--------------|------------------|---------------------|
| 2" x 1.5" | 99 ft. | 45 gpm | 1.0 | 29.8 lbs |

